



DEF SERIES DISPENSER SUMPS

The DEF series dispenser sumps feature all the same benefits as the DCL, CLE and CLS but includes an internal partition to separate the Diesel fuel from the DEF fuel within the sump.



Dual Compartment

An internal containment compartment separates fuel products from DEF (Diesel Exhaust Fluid) while still utilizing a single powder coated steel frame.

HEAVY-GAUGE STEEL FRAMES

The dispenser sump frame is manufactured from heavy gauge steel, providing strength and rigidity, and is designed to lock into the concrete foundation.

SINGLE CONDUITLESS ENTRY

Electrical Conduit can enter into the bottom of the dispenser without penetrating the sump walls, creating less risk for water intrusion.

SINGLE PIECE CONSTRUCTION

Eliminates any seams and provides less places for water penetration.

1" COMPOSITE RAINLIP

Prevents surface water from entering the sump and offers better protection against rust and corrosion than metallic rainlips.

UNIVERSAL STABILIZER BARS

Universal stabilizer bars with 3-axis adjustment accommodate multi-product dispensers without displacing product lines and ensure proper load transfer in case of an impact from any direction.

100% FIBERGLASS

100% high quality, non-corrosive fiberglass provides long-term reliable containment from fuel exposure without voiding warranty, warping, cracking or becoming brittle.

'BRITE-WHITE' INTERIOR

Our signature 'Brite-White' interior reflects light for better visibility and makes identifying leak points easier.

DUO-MOLDED TECHNOLOGY

Our fiberglass sumps utilizes Duo-Molded Technology. Using premium raw materials with a high glass content, we create two layers of fiberglass, offering superior strength and fuel resistance.

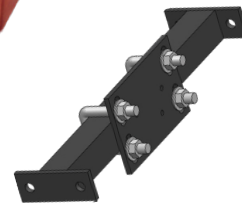

Powder Coated Shear Valve Stabilizer Assembly Kit (Sold Separately)

DOUBLE WALL OPTIONS

Available in double wall for a variety of monitoring options to satisfy local regulations and requirements. From dry fluid or fluid filled interstitial to vacuum interstice monitoring, PCI has all options to best fit your installation and compliance needs.



DEF SERIES DISPENSER SUMPS

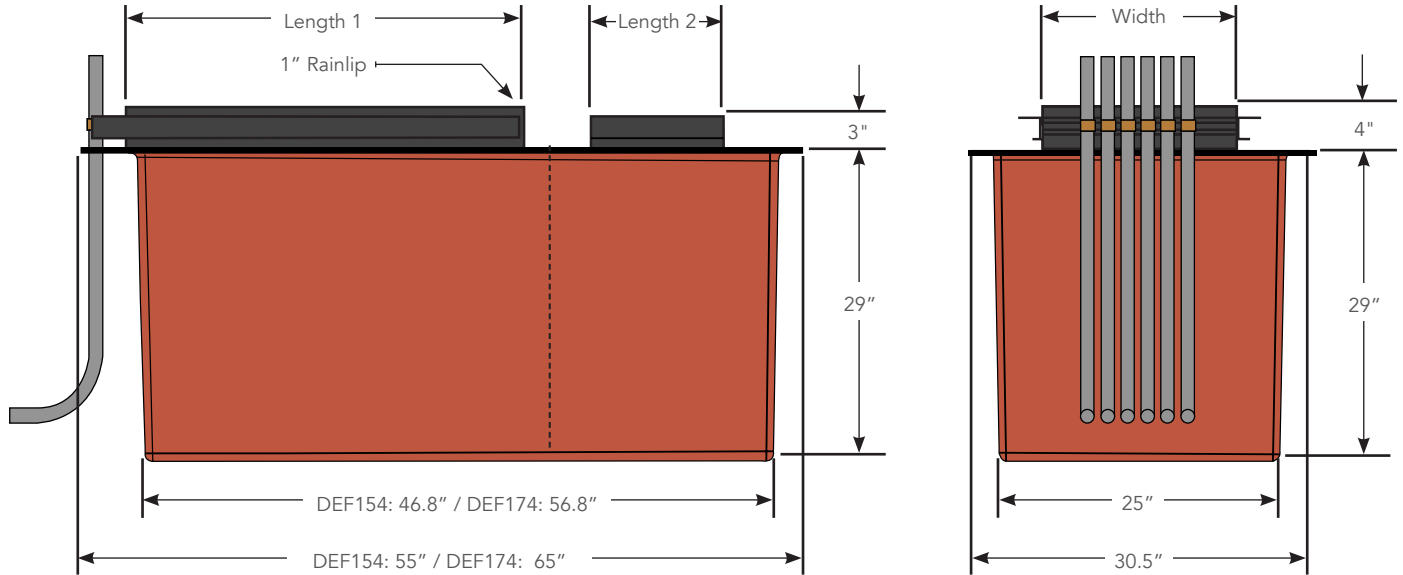

Dispenser Model	DEF Series	Double Wall	Stabilizer Kit	Length 1	Length 2	Width
Gilbarco Encore w/ DEF	DEF174360	DEFDW174360	SVU-L/SVA800DEF	36"	12"	17.5"
Wayne Ovation HS w/ DEF	DEF154282O	DEFDW154282O	SVU-L/SVU-S	28.25"	18"	15.5"
Wayne Vista HS w/ DEF	DEF154282V	DEFDW154282V	SVU-L/SVU-S	28.25"	17"	15.5"

