

ANALOG INVENTORY & LEAK DETECTION PROBES

Analog inventory and leak detection probes provide accurate tank level monitoring and reporting with optional leak detection capabilities. These probes employ magnetostrictive position measurement technology to accurately report inventory levels in storage tanks.

HIGHLIGHTS

- Models available for inventory control or inventory control with leak detection.
- Capable of precise leak detection, density measurement, and inventory monitoring.
- Suitable for use with gasoline, diesel, DEF/AdBlue®, and other manufacturer approved products.
- Bottom mounted installation for fast and simple install.
- Screw-in electrical connector provides quick installation or removal, eliminating the need to re-splice wires.
- Probes are available in many sizes that are suitable for all common tanks.
- Easily installed into 2", 3" or 4" riser pipes.

SPECIFICATIONS

Operating Temperature	-40° to 140° F (-40° to 60° C)
Storage Temperature	-40° to 158° F (-40° to 70° C)
Non-linearity	±0.025% of full scale
Repeatability	±0.001"
Temperature Sensors	5 thermistors located in the shaft
Temperature Resolution	±0.02° F (±0.01° C)
Probe Cable	10' long three conductor cables with shields and polyurethane jacket
Float Compatibility	Up to 3 floats for product, water, phase separation detection, or density measurement
ATG Compatibility	EVO™ Series, TS-5, TS-550, TS-5000, Colibri®, TS-1001/2011/750/504/508
Approvals/Certifications	UL & cUL listed, ATEX, IECEx

Applications

- The leak detection probes are typically used for underground storage tanks and petroleum applications when static or SCALD leak detection is required.
- The inventory control probes are typically used for aboveground storage tanks, chemical or oil waste, or underground storage tanks that do not require in-tank leak detection.



Inventory & Leak Detection Probe
(Shown with optional precision density diesel float kit)

Inventory Probe
(Shown with optional 4" gas float kit)

SPECIFICATIONS CONTINUED

Components

- 1 Probe head
- 2 Guides
- 3 Bottom mount fitting
- 4 Probe shaft
- 5 Product float
- 6 2" or 4" gas, diesel or phase separation water floats
- 7 Precision or standard density float
- 8 LPG float
- 9 Chemical float

Note: All float kits sold separately.

Operation

An electromagnetic field is created inside the probe head and forms around a long waveguide within the probe shaft when position measurements are taken. The electromagnetic field interacts with the magnetic field of the float(s) and produces a shock wave in the waveguide that travels at a known speed. When the shock wave is detected at the probe head, the probe creates a signal that corresponds precisely to the product level. Product expansion calculations are enabled by temperature sensors that are located at various points in the probe shaft.

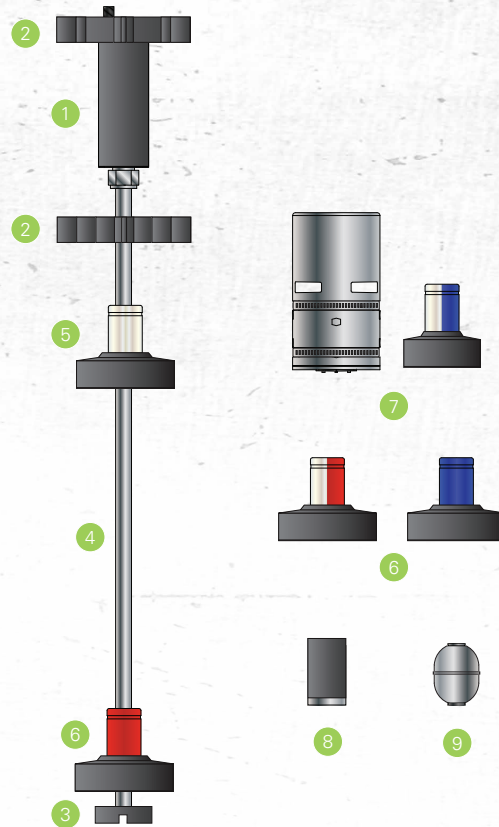

ORDERING INFORMATION

Leak Detection Probes

Model	Description
TSP-LL2-101 CN	101" analog leak detection probe
TSP-LL2-113 CN	113" analog leak detection probe
TSP-LL2-125 CN	125" analog leak detection probe

Inventory Control Probes

Model	Description
TSP-LL2-101-I CN	101" analog inventory probe
TSP-LL2-113-I CN	113" analog inventory probe
TSP-LL2-125-I CN	125" analog inventory probe
TSP-LL2-158-I	158" analog inventory probe
TSP-LL2-161-I	161" analog inventory probe
TSP-LL2-167-I	167" analog inventory probe
TSP-LL2-168-I	168' analog inventory probe
TSP-LL2-170-I	170" analog inventory probe
TSP-LL2-173-I	173" analog inventory probe
TSP-LL2-179-I	179" analog inventory probe
TSP-LL2-185-I	185" analog inventory probe
TSP-LL2-197-I	197" analog inventory probe
TSP-LL2-209-I	209" analog inventory probe
TSP-LL2-215-I	215" analog inventory probe